

FLUID HANDLING:

Compact Panel Unit

A compact, permanently mounted, and continuous-duty filtration system that's designed for critical applications and difficult-to-access equipment. Or, it can serve as a maintenance station.



The Overview

The Compact Panel Unit:

Where It's Used

- Decontaminating systems
- Collecting oil samples for analysis

What Are the Features?

- Automatic pressure relief valve
- Compact size—60% smaller than our standard unit
- Plastic removable drip pan
- Industrial powder-coated paint
- One-year warranty

What Can I Customize?

- Flow rates
- Sample valves
- Color
- Micron rating of filter

Call Des-Case for the

Following Needs:

- Particle counters
- Hydraulic plumbing hoses
- Viton® gaskets
- High viscosity push button sample valves

Performance

For filtering mineral-based industrial oils and most synthetic oils with a maximum operating viscosity range of ISO VG 680 (3000ssu/648cSt) at 100°F/38°C within ambient temperature ranges of -15°F to 150°F (-26°C to 66°C)

Materials:

- Frame: Carbon steel
- Paint: Industrial powder coat
- Filter Heads: Aluminum
- Fittings: Zinc plated steel and/or brass
- Pumps: Aluminum/steel
- Gaskets: Buna-N

Filter Indicators:

- Filter indicator pops at 22psid (1.55bar) as warning that filter elements need to be replaced

Pump Relief:

- Opens at 65psi (5.49bar)

Weight:

- Approximately 45-50lbs (will vary depending on options selected)

Dimensions:

- 10.2"L x 18.2"W x 18.1"H

The Specs

Item No.	Description	Qty.
1	Motor	1
2	Gear Pump	1
3	Filter Element	1
4	Removable Drip Tray	1
5	Inlet Port	1
6	Outlet Port	1
7	Filter Head	1
8	Pressure Gauge	1
9	Sample Valve	1
10	Pump Relief - 65psi	1

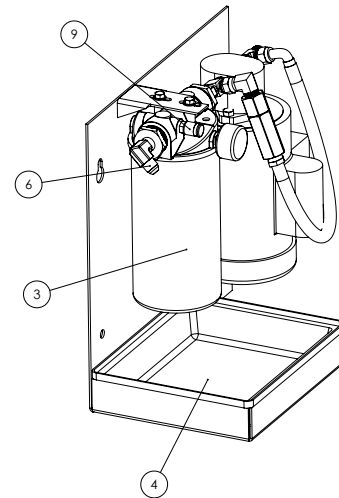
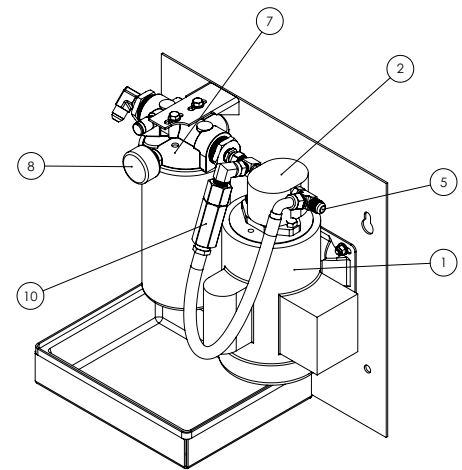

Did You Know?

New oil should be filtered to two (2) ISO levels cleaner than the target cleanliness of the intended component.

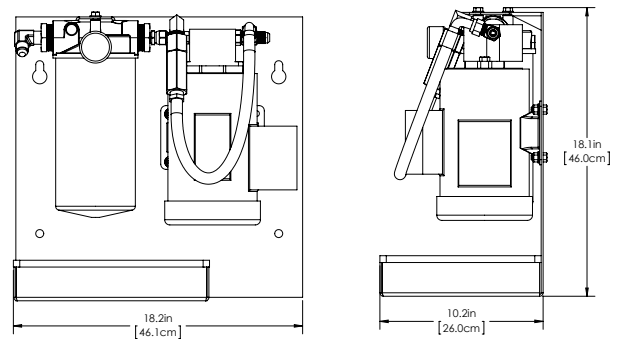

TO ORDER:

Compact Panel Unit

CP				
Box 1	Box 2	Box 3	Box 4	

Pump/Motor Combinations [Box 1]

60 Hz Options		50 Hz Options	
High Viscosity Option (ISO VG 150 to ISO VG 460 at to 100°F)			
Code	Description	Code	Description
01E	1gpm/.25 hp electric, 115 vac, 60 Hz, 1725 rpms, 5 amps	01G	.75gpm/.25 hp electric, 110 vac, 50 Hz, 1425 rpms, 5.4 amps
01F	1gpm/.25 hp electric, 230 vac, 60 Hz, 1725 rpms, 2.5 amps	01H	.75gpm/.25 hp electric, 220 vac, 50 Hz, 1425 rpms, 2.7 amps
Low Viscosity Option (Up to ISO VG 100 at 60°F to 100°F)			
03E	3.5gpm/.25 hp electric, 115 vac, 60 Hz, 1725 rpms, 5 amps	03G	2.75gpm/.25 hp electric, 110 vac, 50 Hz, 1425 rpms, 5.4 amps
03F	3.5gpm/.25 hp electric, 230 vac, 60 Hz, 1725 rpms, 2.5 amps	03H	2.75gpm/.25 hp electric, 220 vac, 50 Hz, 1425 rpms, 2.7 amps

NOTE: Performance will vary depending on operating temperature, fluid type and unit options. Call Des-Case for assistance in choosing a flow rate specific to your needs.

Filter A [Box 2]

Code	Description
A	5-micron Particulate Filter
B	7-micron Particulate Filter
C	12-micron Particulate Filter
D	22-micron Particulate Filter
J	Water Filter

Sample Valves [Box 3]

Code	Description
0	None
1	Standard Minimes
2	High Viscosity

Custom Colors [Box 4]

Code	Description
1	Brushed Aluminum
2	Black
3	White
4	Blue
5	Red
6	Yellow

For Future Reference: Replace Your Elements

Part No.	Micron Rating
DC-S10000S08BBU	Beta 1000 @ 5um
DC-S10000S08CBU	Beta 1000 @ 7um
DC-S10000S08EBU	Beta 1000 @ 12um
DC-S10000S08FBU	Beta 1000 @ 22um
DC-S10000W08FBU	Water Removal

You also can customize your system online at www.descase.com.

FLUID HANDLING:

The Entire Des-Case Line

We offer a full range of fluid handling and filtration products in Portable Filtration, Dedicated Filtration, Water Removal, Lubricant Storage & Filtration, Filter Elements, and Adapter Kits to suit your needs.

Customize your system today at www.descase.com.